

CUSTOMER COPY

REV.	DESCRIPTION	APP.	DATE
A	NEW DESIGN	Amos	2010-05-24

ORDER INFORMATION

1204 5 12 XX X

1:Plating Tin

No. of Contact

12:180° SMT Reel Packing

P1250 RoHS Type

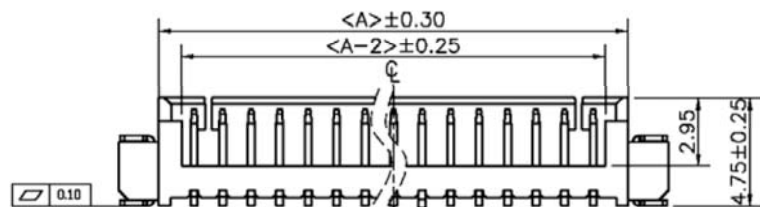

(2~3pin的只有一个在中间)  
(如上图示)

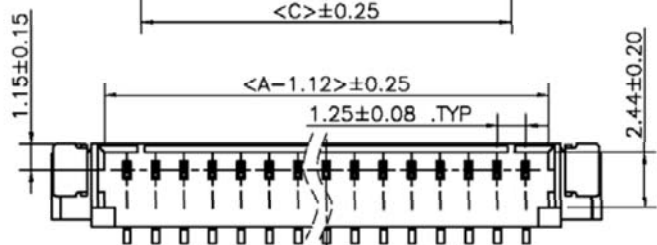
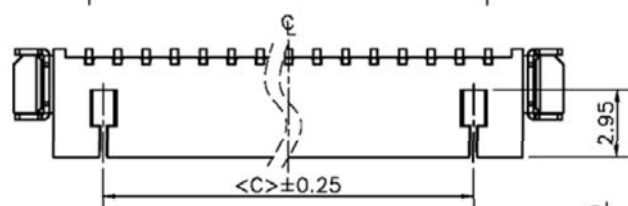
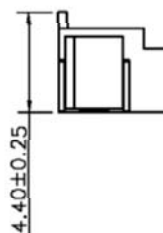
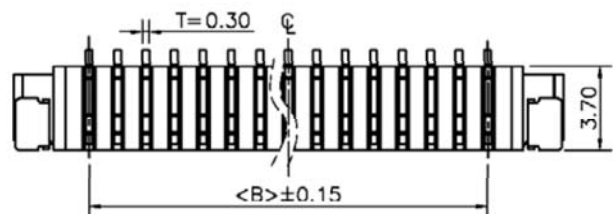

Recommended P.C.B Layout(Top Side)  
P.C.B Thickness = 1.20mm (Tolerance=±0.05)

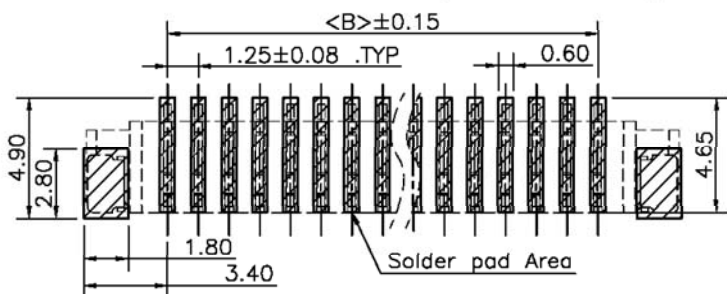

NOTES:

Current Rating: 1A AC,DQ  
Voltage Rating: 125V AC,DQ  
Temperature Range: -25°C AC/85°C  
Contact Resistance: 20m max  
Insulation Resistance: 100M min  
Withstanding Voltage: 250V  
Material: PA6T UL 94V-0

PART NO.	Dimensions		
	A	B	C
S2P	4.25	1.25	
S3P	5.50	2.50	
S4P	6.75	3.75	2.50
S5P	8.00	5.00	3.75
S6P	9.25	6.25	5.00
S7P	10.50	7.50	6.25
S8P	11.75	8.75	7.50
S9P	13.00	10.00	8.75
S10P	14.25	11.25	10.00
S11P	15.50	12.50	11.25
S12P	16.75	13.75	12.50
S13P	18.00	15.00	13.75
S14P	19.25	16.25	15.00
S15P	20.50	17.50	16.25



鈺滿榮企業股份有限公司 ACME LUX CO., LTD.

TEL: 886-2-85124595 FAX: 886-2-85124322

0.0±0.30	Scale: 1:1	Title: Pitch 1.25mm 180° SMT Type Wafer Connector	PART NO:
0.00±0.20	Unit: mm		APP BY: Hung
0.000±0.1			CHK BY: Cheryl
		Material: RoHS	DR BY: Amos
		DWG. NO. C1204512XXX	A303

